

Universal Vent Free

ANSI Z21.91 & ANSI Z21.11 Certified

36" Peninsula Vent Free Fireplace

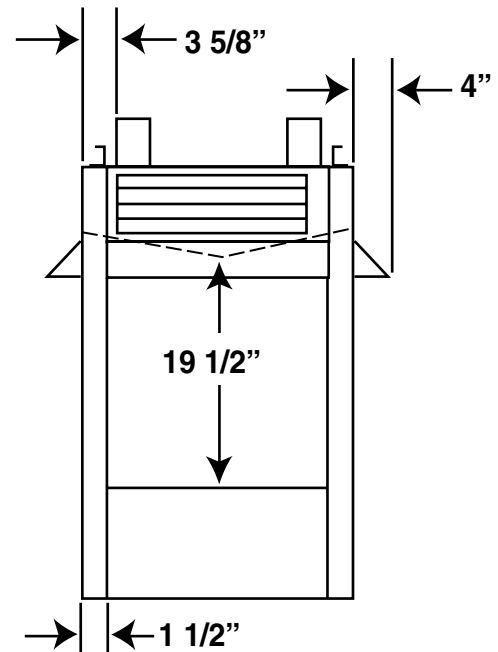
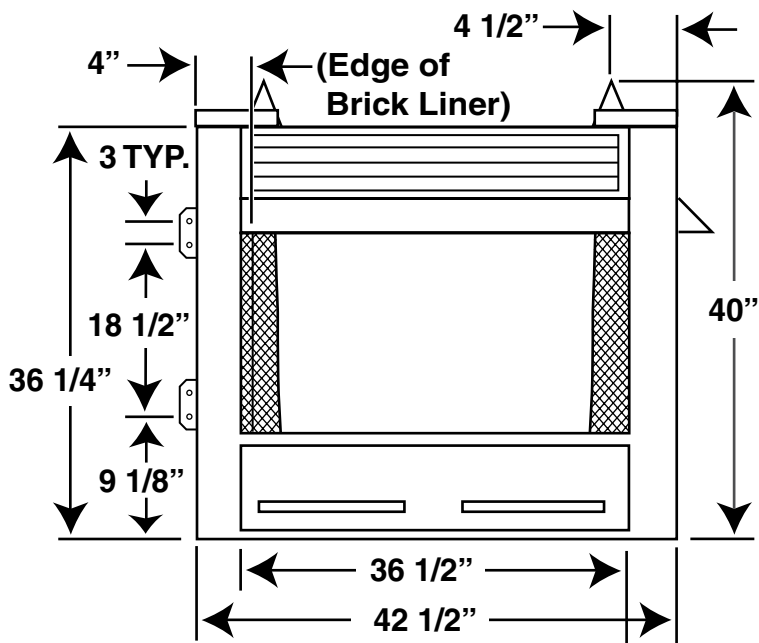
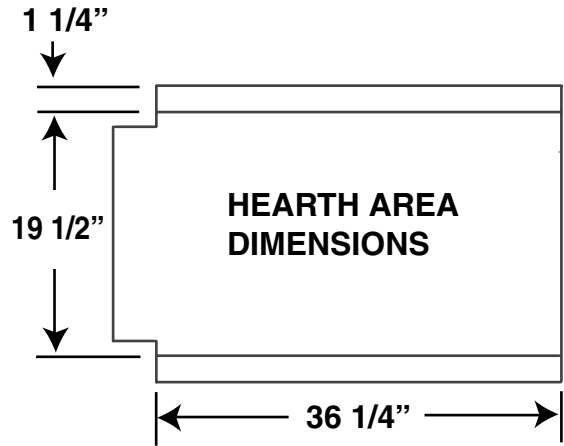
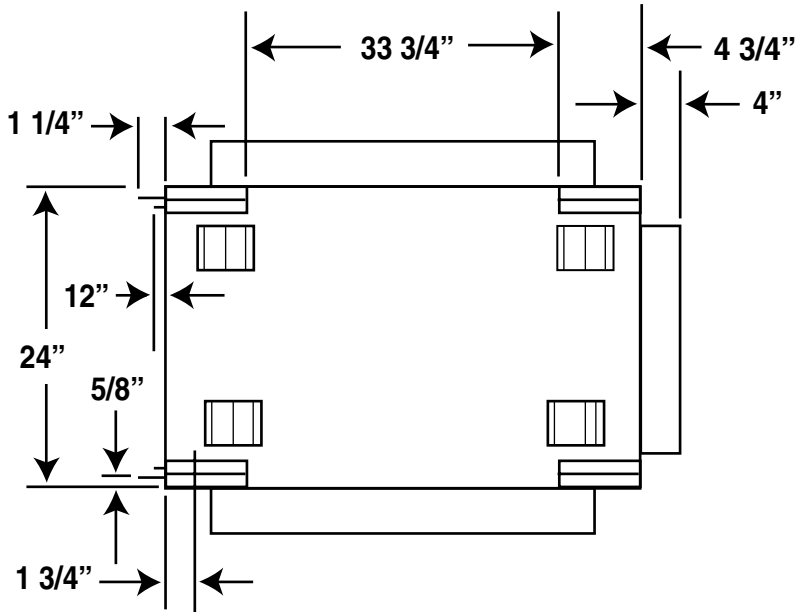

36" Universal Peninsula Vent Free Fireplaces

Framing Dimensions

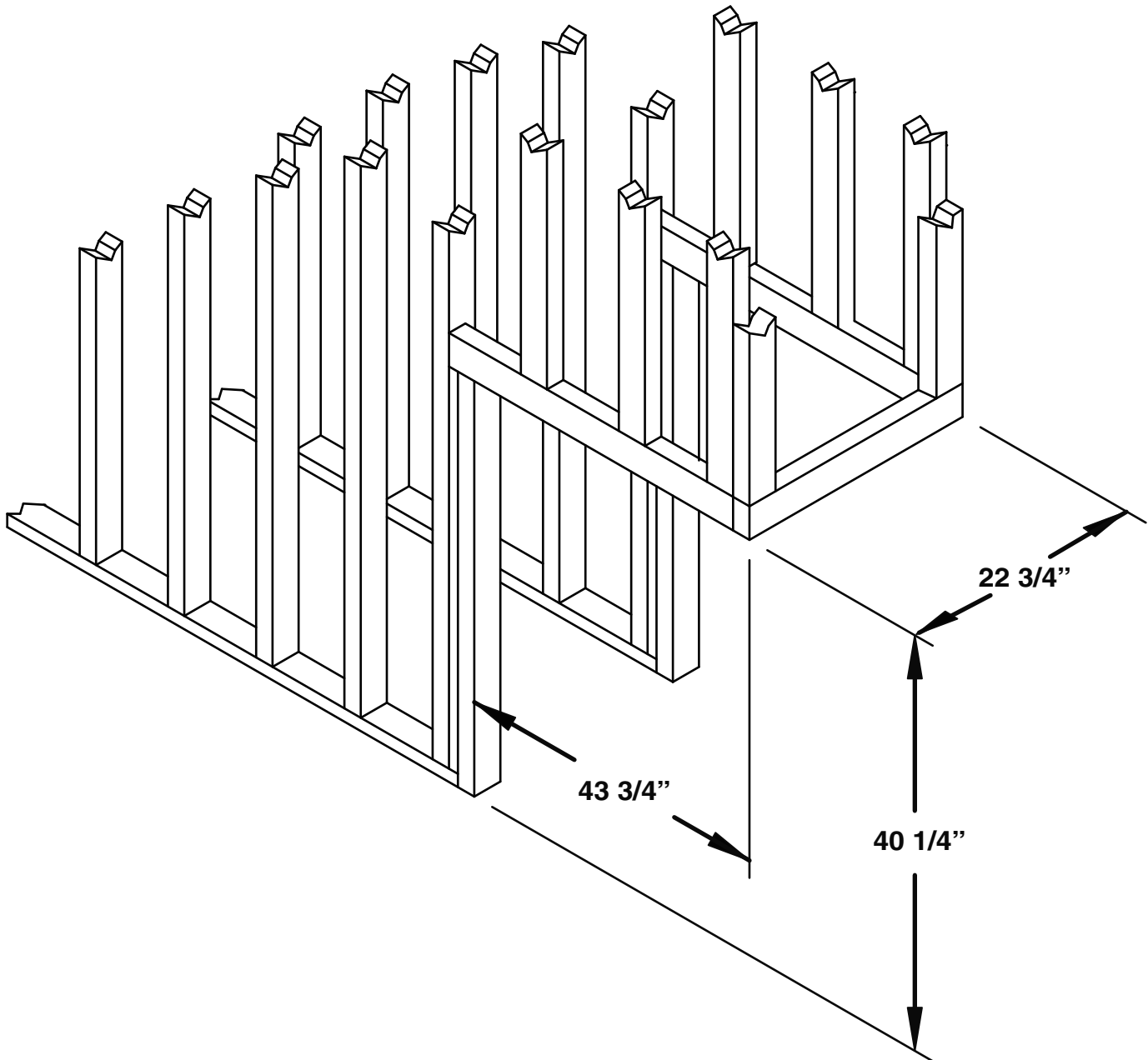

NOTE:

Built-in Features Such as Mantels, Bookshelves, etc. Made of Combustible Materials Must Maintain Minimum-Clearances from the Fireplace. See Installation Instructions for Complete Information.

“Product design, features and specifications are subject to change at any time. Refer to current product instructions prior to installation.”